

F9 Concentrated load transfer (squash blocks).

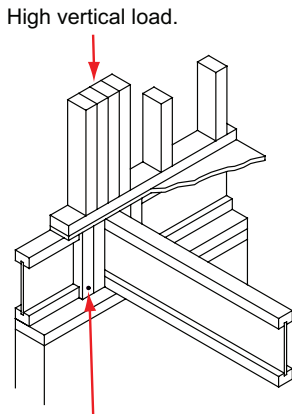

Provide squash blocks where vertical load exceeds rim capacity (see page 51 of the technical guide).

F11 Backer block (face mount hanger).

Note: Fix backer block using 8-No 3.35x65mm nails clenched (see F11b). Use 100mm nails for 90s series joist.

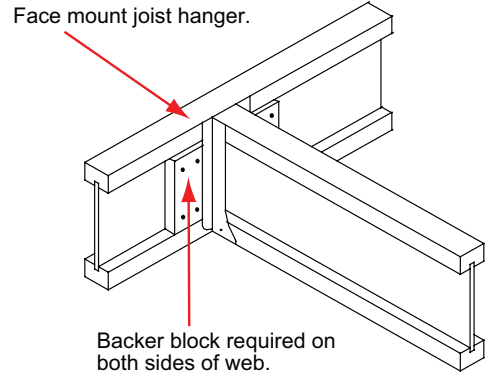

Backer block required on both sides of web.

F10

Web stiffeners (fixing and specification).

Web stiffeners may be used to increase allowable reaction values in the applications below.

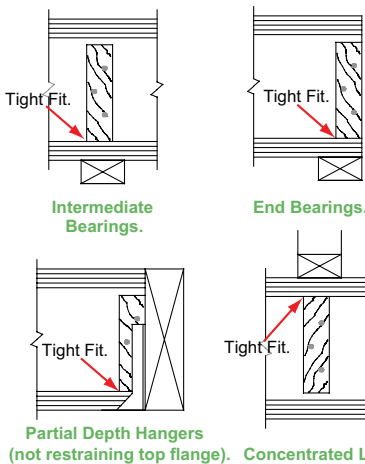

Small gap: 3mm min. 50mm max.

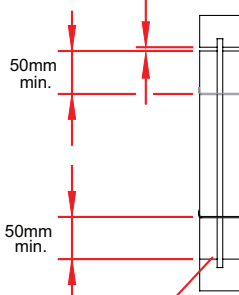

Joist Depth	Fixings
241	2-No 3.35x65mm
302	3-No 3.35x65mm
356	5-No 3.35x65mm
406	6-No 3.35x65mm

Note: Use 100mm nails for 90s Series Joists.

All Nails to be 3.35 x 65mm driven through and clenched over on far side.

OSB or Plywood web stiffener:

5000s Series	18x60mm min.
6000s Series	22x60mm min.
6500s Series	25x60mm min.
60s Series	22x60mm min.
90s Series	38x60mm min.

Note: Web stiffeners are not required for BCI® Joists unless used in hangers that do not extend up to restrain the top flange of the BCI® Joist or as required by design.

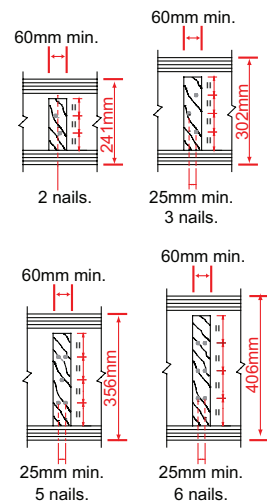

F11a Backer block (top hung hanger).

Note: Fix backer block using 8-No 3.35x65mm nails clenched (see F11b). Use 100mm nails for 90s series joist.

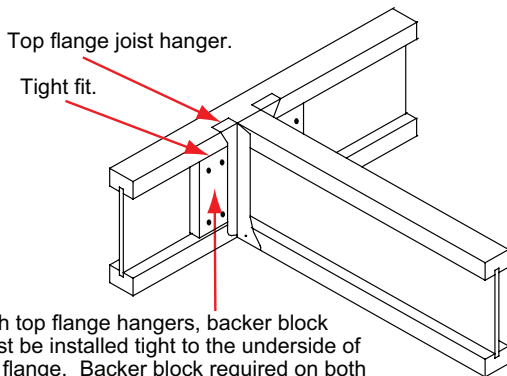

With top flange hangers, backer block must be installed tight to the underside of top flange. Backer block required on both sides of web.

F11b Backer block (fixing and specification).

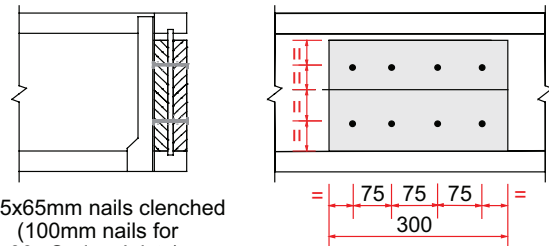

3.35x65mm nails clenched (100mm nails for 90s Series Joists).

Where nails are clenched, all nails can be driven from near side.

Series	Backer Block Thickness	Depth	Backer Block Depths
5000s	20mm wood panel	241mm	147mm
6000s	25mm wood panel	302mm	219mm
6500s	27mm wood panel	356mm	269mm
60s	25mm wood panels	356mm	269mm
90s	18mm + 22mm wood panels	406mm	319mm