

## F5 VERSA-LAM® Rim (parallel to joist - external wall).

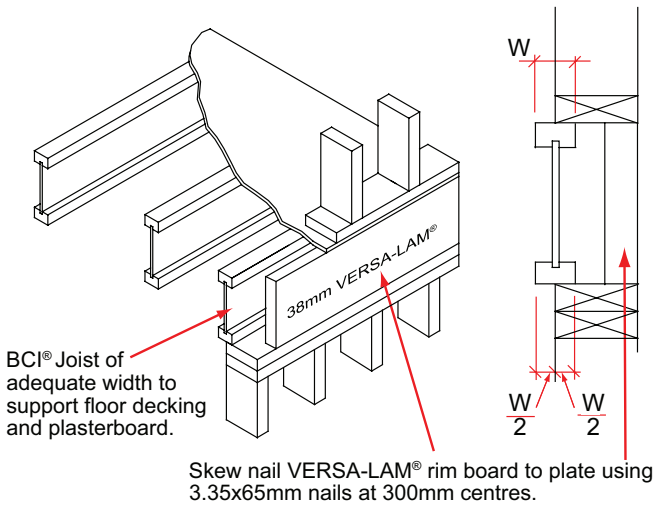

## F5a VERSA-LAM® Rim (parallel to joist - party wall).

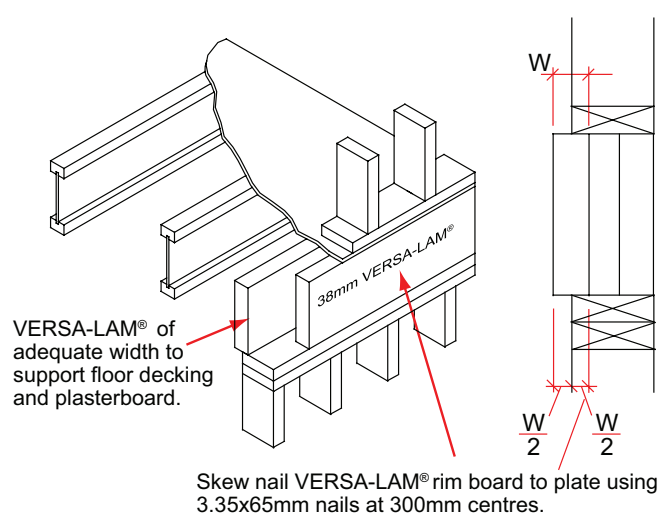

## F6 Joist spliced on load-bearing wall.

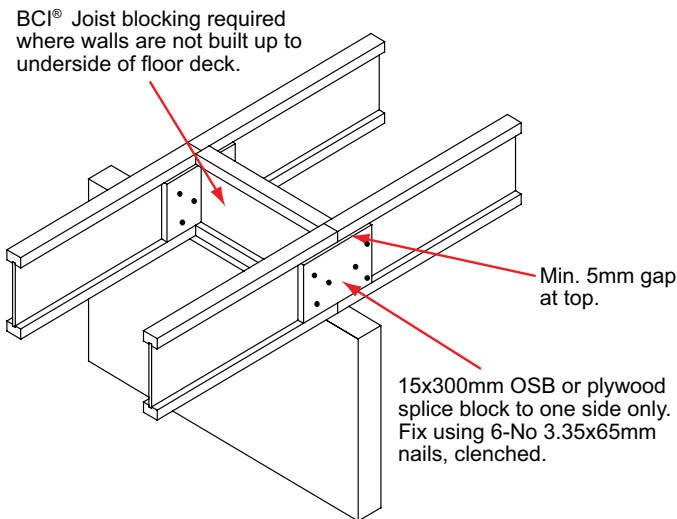

## F7 Non load-bearing stud wall (parallel to joist).

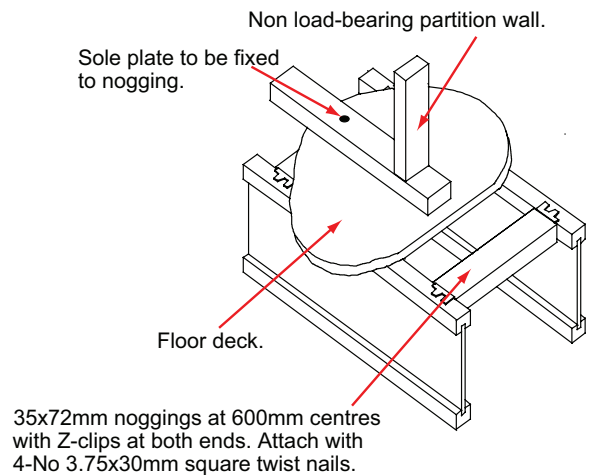

## F8 Wall to wall load transfer (BCI® Joist blocking).

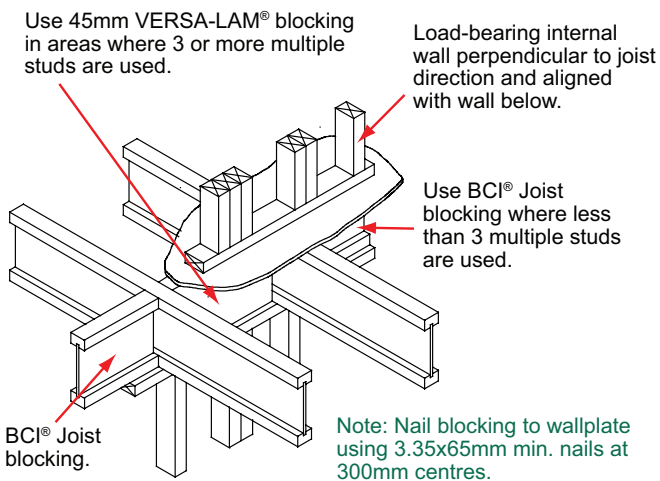

## F8a Wall to wall load transfer (squash blocks).

