

F1 Fixing at end bearing.

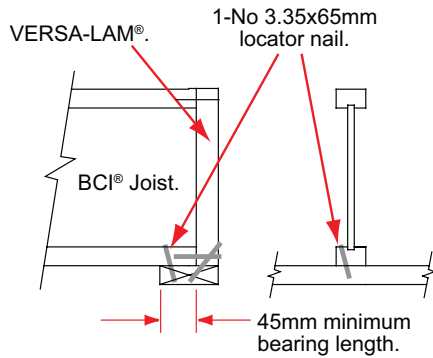

Note: To avoid splitting flange, start locator nail at least 38mm from end. Nails will need to be driven at an angle to prevent splitting of bearing plate.

F1a Party wall end bearing.

For alternative detail, see F4a

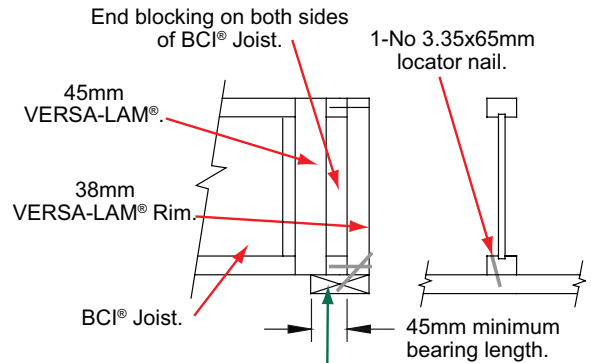

Note: To avoid splitting flange, start locator nail at least 38mm from end. Nails will need to be driven at an angle to prevent splitting of bearing plate.

F2 BCI® Rim blocking.

Note: Nail BCI® rim blocking to wallplate using 3.35x65mm nails each side at 300mm centres. Skew nail top of blocking to joist.

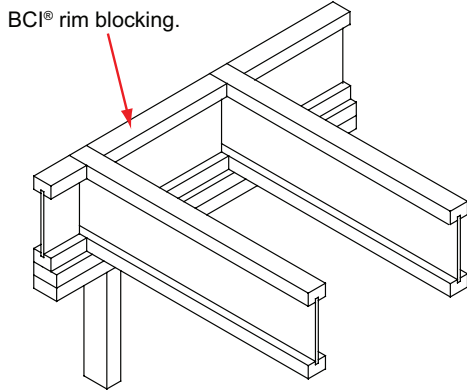

F3a Non load-bearing stud wall (perpendicular to joist).

Perpendicular non load-bearing stud wall.

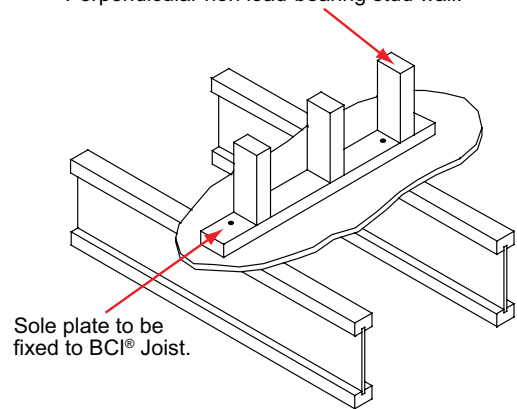

F4 VERSA-LAM® Rim (perpendicular to joist - external wall).

Note: Nail VERSA-LAM® rim board to BCI® Joists with 2-No 3.35x65mm nails, one at the top and one at the bottom (see detail F1).

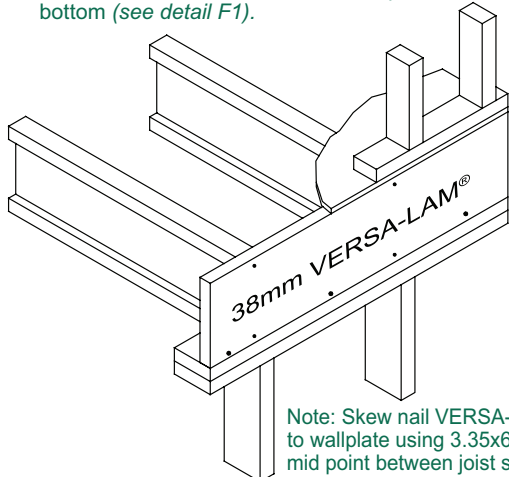

Note: Skew nail VERSA-LAM® rim board to wallplate using 3.35x65mm nails at mid point between joist spacings.

F4a VERSA-LAM® Rim (perpendicular to joist - party wall).

